



DEWMARK
HYDRO

WR 75/100



Joint width
100 mm



Recess
mounted



Max load
300 kN



Movements in
6 directions



Protection
rating IP 67



Indoor/
outdoor

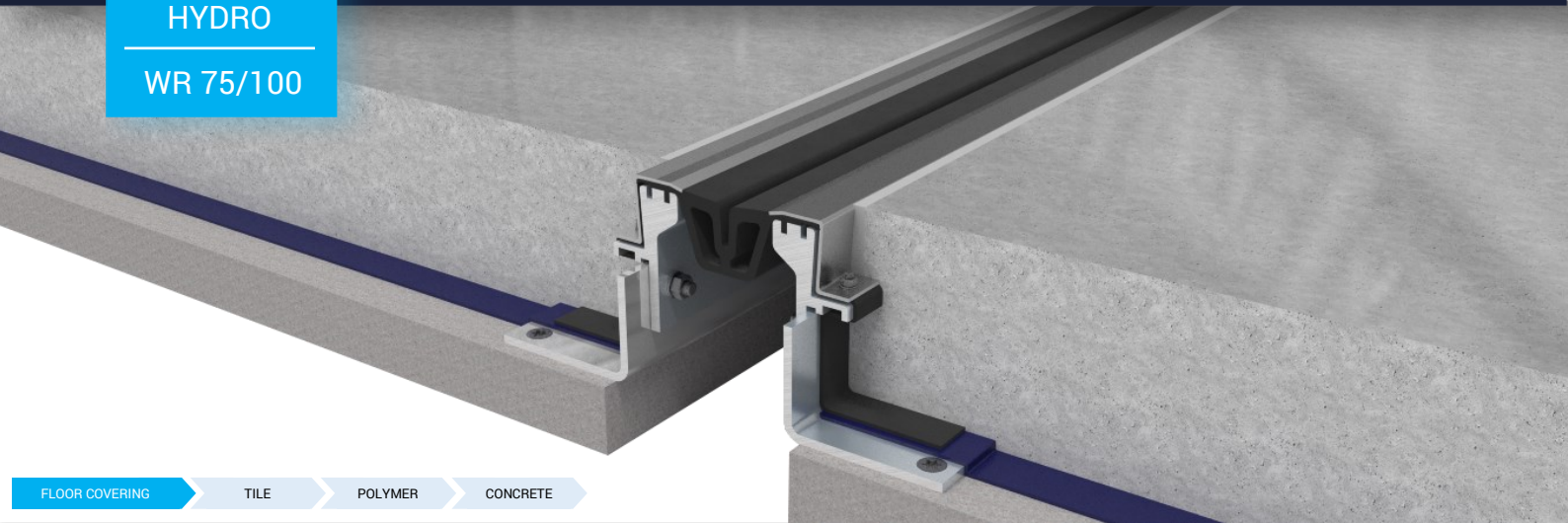

FLOOR COVERING → TILE → POLYMER → CONCRETE

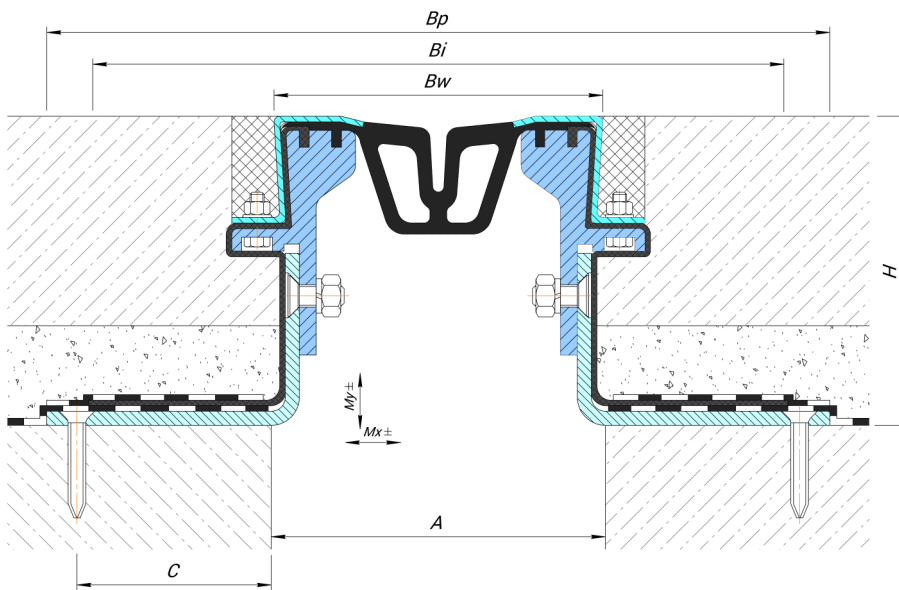

Technical data

MATERIAL

Profile: aluminium EN AW 6060T6
Plates: AISI 430 (AISI 304 or 316 to order)
Insert (shirt): PVC-P (oil and petrol resistant)

LENGTH

Profile: 2.5 meters
Plates: 2.5 meters
Insert: 25 meters
Shirt: 50 meters

STANDARD COLOR OF INSERT (RAL)

9005

Profile	A (mm)	H (mm)	Bw (mm)	Bp (mm)	Bi ¹ (mm)	C (mm)	Hp (mm)	Mx (mm)	My (mm)	Load bearing capacity, kN			
WR 75/100/88	100	88	118	260	O/R ¹	65	5	80 (+40/-40)	20 (+10/-10)	50	300	70	—
WR 75/100/98	100	98	118	260	O/R ¹	65	5	80 (+40/-40)	20 (+10/-10)	50	300	70	—
WR 75/100/108	100	108	118	260	O/R ¹	65	5	80 (+40/-40)	20 (+10/-10)	50	300	70	—
WR 75/100/128	100	128	118	260	O/R ¹	65	5	80 (+40/-40)	20 (+10/-10)	50	300	70	—
WR 75/100/148	100	148	118	260	O/R ¹	65	5	80 (+40/-40)	20 (+10/-10)	50	300	70	—
WR-H 75/100/A ²	100	O/R ²	118	O/R ³	O/R ¹	75	5	80 (+40/-40)	20 (+10/-10)	50	300	70	—

¹ Bi - shirt width. Depends on the type of shirt and the mounting height of the profile. Ask for additional information.

² The profile can be made to any height from 85 to 1000 mm. In this case, it is completed with steel guide angles to the required mounting height. **A** - the value of the selected profile height.

³ Depends on the installation height of the profile.

On request

The profile can be completed with an capping the insert to protect against mechanical damage (this profile will have an index F).

Example: WR-H 75/100/150 F

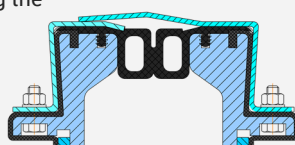

Corner Versions

All profiles have angular versions in which the regular insert is replaced with an angular one.

This profile has an E index.

Example: WR-E-H 75/100/150

