



DEWMARK
HEAVY

SV 41/195



Joint width
195 mm



Recess
mounted



Max load
30 kN



Movements in
3 directions



Protection
rating IP 30



Indoor/
outdoor



FLOOR COVERING → TILE → POLYMER → CONCRETE

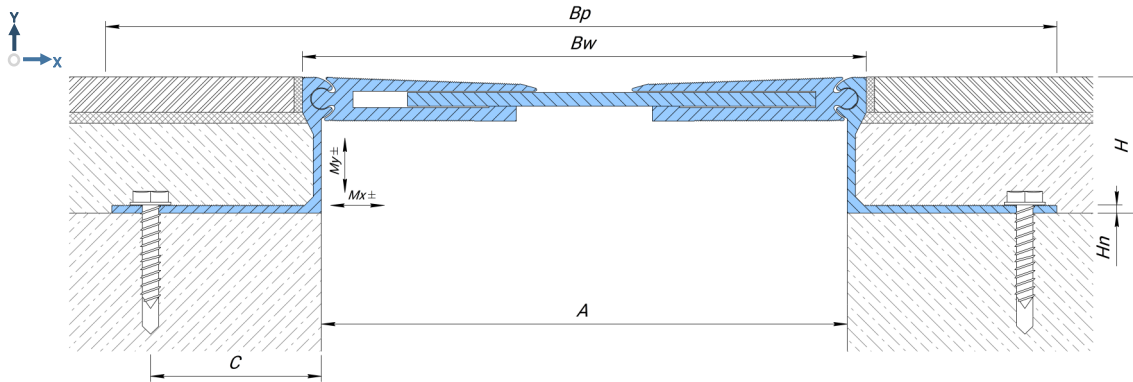

Technical data

MATERIAL

Aluminium EN AW 6060T6

LENGTH

3 meters

STANDARD COLOR

silvery white

Profile	A (mm)	Bw (mm)	Bp (mm)	H (mm)	Hn (mm)	C (mm)	Mx (mm)	My (mm)	Load bearing capacity, kN			
SV 41/195/16	195	210	325	16	2,3	50	40 (+20/-20)	40 (+20/-20)	30 ¹	-	-	-
SV 41/195/20	195	210	344	20	3	60	40 (+20/-20)	40 (+20/-20)	30 ¹	-	-	-
SV 41/195/25	195	210	340	25	3	60	40 (+20/-20)	40 (+20/-20)	30 ¹	-	-	-
SV 41/195/34	195	210	350	34	3	60	40 (+20/-20)	40 (+20/-20)	30 ¹	-	-	-
SV 41/195/50	195	210	348	50	3	60	40 (+20/-20)	40 (+20/-20)	30	-	-	-
SV 41/195/70	195	210	345	70	3,5	60	40 (+20/-20)	40 (+20/-20)	30	-	-	-
SV 41/195/80	195	210	349	80	3,5	60	40 (+20/-20)	40 (+20/-20)	30	-	-	-
SV 41/195/100	195	210	345	100	4	60	40 (+20/-20)	40 (+20/-20)	30	-	-	-
SV 41/195/120	195	210	345	120	4	60	40 (+20/-20)	40 (+20/-20)	30	-	-	-
SV 41/195/150	195	210	353	150	4,5	60	40 (+20/-20)	40 (+20/-20)	30	-	-	-

On request

Other profile heights on request

Protective anodizing profile

Corner versions

All profiles have an corner version (wall to floor under an angle of 90 degrees).

One of the guides is replaced by an corner guide.

This profile is denoted by the index "E":

example SV-E 41/195/50

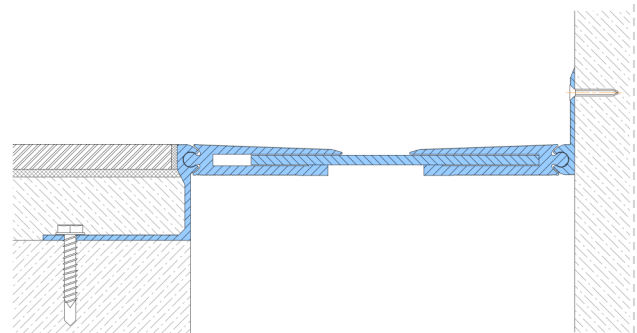

! For corner versions, only pedestrian loads are allowed.